

# Allied Academies’ Spring International Conference Program Schedule

## Table of Contents and Special Highlights

Letter from the Conference Chairs ..... 2

Registration ..... Dogwood (F)  
     Thursday ..... 7:30 AM to 3:30 PM  
     Friday ..... 7:30 AM to 3:30 PM

Simultaneous Sessions in Meeting Rooms:  
     Tupelo (D), Magnolia (E), Cypress (G), Live Oak (B), and Executive Conference Room

    Wednesday Internet Sessions ..... pages 3 - 4

    Thursday: Simultaneous Sessions Scheduled for:  
     8:00-10:00 AM, 10:10 AM-12:10 PM, 12:50-2:50 PM, 3:00-5:00 PM ..... pages 5 - 16

    Friday: Simultaneous Sessions Scheduled for:  
     8:00-10:00 AM, 10:10 AM-12:10 PM, 12:50-2:50 PM, 3:00-5:00 PM ..... pages 17 - 31

    Saturday Internet Sessions ..... pages 32 - 33

Dinner Buffet, Awards Reception, and Cash Bar ..... Live Oak Ballroom (C)  
     Bar Opens at 6:00; Dinner Begins at 6:30                      Friday 6:00 PM to 8:30 PM, page 31

Award Winners ..... page 34

Index of Participants ..... page 43

Map of the Casino and Conference Facilities ..... page 46

**Please Note that Admittance to the Awards Dinner Requires a Dinner Ticket**

**Please wear your name badge to all functions.  
Welcome to Tunica!**

## **Letter from the Conference Chairs**

Welcome to Tunica! We hope that you will enjoy your stay here and that the Conference will prove to be a successful one for each of you. This is the fourteenth year of the Allied Academies. As you know, the organization is a not for profit corporation and is not sponsored by any university or organization. We are dependent upon conference registration fees and membership fees. Our mission is to support and encourage the exchange of ideas in higher education throughout the world. To that end, we sponsor conferences and publish journals. In addition, we maintain a web page which has developed into an important communication medium for our membership and for scholars from around the world. We publish our journals simultaneously in hard copy and on the web page, and you can view conference proceedings, newsletters and academy information there as well.

We are pleased to report that this conference features work which represents a great range of ideas and contributions: from cutting edge contributions to the literature, to pedagogic and educational applications, to applied and practical research. As an interdisciplinary organization, we hope that each of you will find concepts and ideas which you can use in a variety of areas. We encourage you to venture outside your disciplines and to sample the work of your peers from across the spectrum of academe. To that end, and to facilitate our participants' choice of participation time, we have structured the Conference in the form of interdisciplinary sessions. We hope that each of you will take this opportunity to expand your interests.

We also encourage you to sample the food and fun which is abundantly available in beautiful Tunica. We recognize that the camaraderie of the resort is as important in revitalizing you as a professional as are the discussions in the presentations. We hope that each of you will go home refreshed, renewed, and with new and lasting friends.

Finally, we would like to extend our heartfelt appreciation to each of you. It is the authors and the conference participants who make the Allied Academies successful and who support our efforts to achieve our mission. Thank you and have a great conference!

JoAnn and Jim Carland  
[www.alliedacademies.org](http://www.alliedacademies.org)

**Interdisciplinary Internet Session**  
**Session Chair: Jim Carland, Allied Academies**

*Export Controls and Their Effect on Business Operations*

Debra Burke, Western Carolina University  
Mary Anne Nixon, Western Carolina University  
LeVon Wilson, Georgia Southern University

*Oklahoma Enviroserv Specialists LLC: A Case for Environmentally Friendly Ethical Growth*

Stefanie Bookout, Cameron University  
Shawn Carraher, Cameron University

*Using Financial Statement Analysis to Explain the Variation in Firms' Earnings-Price Ratios*

Charles Jordan, University of Southern Mississippi  
Stanley Clark, University of Southern Mississippi  
Mallory Donald, University of Southern Mississippi

*Technological Factors & Business Faculty Stress*

Barbara Schuldt, Southeastern Louisiana University  
Jeffrey Totten, McNeese State University

*CULE Camp On-line: Ethically Educating Students to Be Entrepreneurs and Leaders*

Sylvia Burgess, Cameron University  
Cynthia Johnson, Cameron University  
Shawn Carraher, Cameron University  
John Courington, Cameron University

*The Dressing Room: Ethical Leadership in Dining Choices*

Lisa Negrón, Cameron University  
Roger Miller, Cameron University  
Dianna Ryan, Cameron University  
Shawn Carraher, Cameron University

*Rank, Grade, and Pay: Examining the Basic Service Perceptions of Commissioned Officers Versus Non-Commissioned Personnel of a Southern State Defense Force*

William Sumrall, Belhaven College  
Don W. Jones, Belhaven College  
Daniel Adrian Doss, Belhaven College

**Interdisciplinary Internet Session**  
**Session Chair: JoAnn Carland, Allied Academies**

*Critiquing a Study of the Market Effectiveness of Internet Media among U.K. Non-profit Organizations*

Daniel Adrian Doss, Belhaven College  
Lacey D. Holland, Mississippi University for Women  
I Chun Lisa Chen, Yuanpei University

*Perspectives and Challenges in the Global Oil and Natural Gas Industry*

Balasundram Maniam, Sam Houston State University  
Adam Wilson, Sam Houston State University

*The Effects of 9-11 on Crisis Response Plans, Crisis Communication Plans, and Succession Planning*

Amy Hurley-Hanson, Chapman University  
Cristina Giannantonio, Chapman University

*Assessing the Ongoing Feasibility of Subprime Business Lending Programs Targeting Minority Entrepreneurs*

Ruby Beale, Hampton University  
Angelique Fowler, Hampton University  
Nathia Nicholas, Hampton University  
Jonathan Turner, Hampton University

*Export Barriers and Performance of Small and Medium Size Enterprises*

Cranmer Rutihinda, Bishop's University

*Client or Student*

Mark Lewis, Arkansas State University  
Jeffrey Pittman, Arkansas State University

*Student Reading Strategies and Textbook Use:  
An Inquiry into Economics and Accounting Courses*

Laura Fitzpatrick, Rockhurst University  
Cheryl McConnell, Rockhurst University

**Interdisciplinary Session**

**Session Chair:** Jong Ha, Columbus State University

*Do Taiwanese Managers Trust Their United Kingdom British Employees?  
A Consideration of Taiwanese Multi-National Corporations in the U.K.*

I Chun Lisa Chen, Yuanpei University

Daniel Adrian Doss, Belhaven College

Lacey D. Holland, Mississippi University for Women

*Causes of Conflicts of Local Information Technology Manager in a Multinational Company*

Jongtae Yu, Mississippi State University

Jong-Wook Ha, Columbus State University

Dong-Yop Oh, University of Alabama

*Correlation of International Bank Rates: 1999-2007*

Casey Hammond, Arkansas State University

*Digit Analysis: An Illustrative Class Exercise*

Mark Linville, Kansas State University

*An Analysis on Internationalization Process of Korean New Venture Firms*

Jong Ha, Columbus State University

Soon-Gwon Choi, Pukyong National University

Sungwoo Jung, Columbus State University

---

8:00 AM to 10:00 AM Thursday, April 3

Cypress (G)

---

**Interdisciplinary Session**

**Session Chair:** David Kunz, Southeast Missouri State University

*Process Performance Measurement with Automatically Collected Data:*

*A Case Study in an Outpatient Clinic*

Markus Kohlbacher, Graz University of Technology

Andreas Gautsch, Knapp Systems Integration

Hartwig Zenz, Steiermaerkische Krankenanstaltengesellschaft

Werner Leodolter, Steiermaerkische Krankenanstaltengesellschaft

*Charging for Medical Telephone Care*

Jeffret Kile, King's College

Bernard J. Healey, King's College

Michele McGowan, King's College

*Empirical Models of Manufacturing Safety Determinants*

Tantatape Brahasrene, Purdue University North Central

Sarah Smith, Purdue University North Central

*Does the Punishment Fit the Crime?*

Melissa Griffin, Arkansas State University

Kenna Henard, Arkansas State University

David Edwards, Arkansas State University

*Missouri Solvents: Managing Cash Flow*

David Kunz, Southeast Missouri State University

Rebecca Summary, Southeast Missouri State University

8:00 AM to 10:00 AM Thursday, April 3

Executive Conference Room

**Interdisciplinary Session**

**Session Chair:** Claudia Rawlins, California State University, Chico

*The Role and Contributions of Academic Research and Publishing:  
An Attitudinal Study of AACSB Accredited Business School Faculty*

Robert Taylor, Radford University  
Angela Stanton, Radford University

*Some Career Implications from the Income Statement:*

*On Marketing Yourself to Top Management*

Richard Carr, University of Arkansas at Pine Bluff

*The Negative Effect of the Marriage Penalty Tax on American Society*

Frederick Feucht, Prairie View A&M University

L. Murphy Smith, Texas A&M University

Robert H. Strawser, Texas A&M University

*An Initial Study into the Personality Types of Undergraduate Business Students*

Amber Morgan, Lander University

Karie Barbour, Lander University

*Just Wishing and Hoping?*

*What the Millennial Cohort Absolutely, Positively Must Have at Work*

Claudia Rawlins, California State University, Chico

Julie Indvik, California State University, Chico

Pamela R. Johnson, California State University, Chico

---

10:10 AM to 12:10 PM Thursday, April 3

Tupelo (D)

---

**Interdisciplinary Session**

**Session Chair:** Jonathan Breazeale, Sam Houston State University

*The Role of Small Business Development in Transitional Economies*

Jung-Wan Lee, Kazakh-British Technical University

Tantatape Brahmasrene, Purdue University North Central

Simon W. Tai, Kazakhstan Institute of Management

*Ergonomics*

Ken Walker, King's College

Bernard Healey, King's College

*Crisis and Volatility:*

*Correlations Between Assassinations, Attempts, and Market Reactions*

Charles Bell, Arkansas State University

*Cape Chemical: Cash and Profits*

David Kunz, Southeast Missouri State University

Benjamin Dow, Southeast Missouri State University

*The Plaza*

Jonathan Breazeale, Sam Houston State University

10:10 AM to 12:10 PM Thursday, April 3

Cypress (G)

**Interdisciplinary Session**

**Session Chair:** Paul Marshall, Widener University

*A Preliminary Study of the Relationships among Consumer Satisfaction, Loyalty,  
and Market Share in Health Club Consumers*

Larry Pleshko, Kuwait University  
Samar Baqer, Kuwait University

*Formal Academic Disciplinary Actions and Entry into the Profession of Accounting*  
Mark Linville, Kansas State University

*From Work-Family Conflicts to Psychological Stress, Job Satisfaction and to Life Satisfaction:  
A Proposed Integrative Model*

Satyanarayana Parayitam, McNeese State University  
Narender Kumar Kalra, Delhi University, India

*Attention Entrepreneurial Small Business Owner:  
Auditing for Success—Follow the Money!*

Kevin Ennis, Mississippi State University-Meridian Campus  
Jack Tucci, Mississippi State University-Meridian Campus

*Real Estate Marketing in Russia and Ukraine Contrasted with American Practice:  
An Update from the Early Post-Soviet Period*

Myrosław Kyj, Widener University  
Paul Marshall, Widener University

---

10:10 AM to 12:10 PM Thursday, April 3

Executive Conference Room

---

**Interdisciplinary Session**

**Session Chair:** Darwin King, St. Bonaventure University

*Financial Literacy and “I Don’t Know”*

Grady Perdue, University of Houston-Clear Lake

Robert Hill, University of Houston-Clear Lake

*The Relationship among Goal Setting, Optimism, and Engagement:*

*The Impact on Employee Performance*

Bobby Medlin, University of South Carolina-Upstate

Ken Green, Jr., Sam Houston State University

*Cycling Boomers: A New Retirement Ideal*

Brett Eldredge, California State University, Chico

Pamela Johnson, California State University, Chico

*Nineteenth Century Cost Accounting Practices and Their Influence on*

*Current Accounting Methodology*

Darwin King, St. Bonaventure University

Kathleen Premo, St. Bonaventure University

Carl Case, St. Bonaventure University

12:50 PM to 2:50 PM Thursday, April 3

Tupelo (D)

**Interdisciplinary Session**

**Session Chair:** John Lambert, University of Southern Mississippi

*An Economic Model for Distributing Body Organs*  
Bernard Healey, King's College

*The Changing Pharmaceutical Selling Environment*  
Christopher Foster, Longwood University  
John Gaskins, Longwood University

*The Effect of Oil Companies Stock Prices after Hurricane Katrina*  
Isaac Weiderman, Longwood University  
Frank Bacon, Longwood University

*Teamwork in the City of Gold: An Arabian Adventure of Modern Management  
Capabilities in the 21st Century Continues*  
James Reagan McLaurin, American University of Sharjah

*The Conservation of Flow: Tenth Law of Conservation*  
Andrei Aleinikov, International Academy of Genius  
Michaella McFarland, International Academy of Genius

*Imported Product Acceptance When National Origin Is Not an Issue:  
The Influence of Personal Choice in a Low Cetscale Environment*  
John Lambert, University of Southern Mississippi  
Adrine Harrell, University of Southern Mississippi

---

12:50 PM to 2:50 PM Thursday, April 3

Cypress (G)

---

**Interdisciplinary Session**

**Session Chair:** Wayne Roberts, Southern Utah University

*The Impact of Executive Coaching on Executive Performance*  
Bruce Blaylock, Radford University

*The International Student and POM: Statistics Anxiety*  
James Bell, University of Central Arkansas

*The Effects of Motor Vehicle Wealth Taxes on Households' Vehicle Purchase Decisions*  
Karie Barbour, Lander University

*The Importance of Produce in Grocery Shopping for University Students in the Midwest*  
Marty Meyers, University of Wisconsin at Stevens Point

*Pilot Study to Help Determine the Perceptions of Small, Downtown Retailers  
Regarding Outshopping*  
James Ricks, Southeast Missouri State University  
Dianne Pettypool, Southeast Missouri State University

*Student Evaluations of Teaching Effectiveness: A Marketing Research Perspective*  
Wayne Roberts, Southern Utah University

12:50 PM to 2:50 PM Thursday, April 3

Executive Conference Room

**Interdisciplinary Session**

**Session Chair:** Michael W. Boyd, Western Carolina University

*Principles of Management Text's Coverage of Entrepreneurship,  
Creativity/Innovation and Technology*

Steve Brown, Eastern Kentucky University

Peggy Brewer, Eastern Kentucky University

*An Exploratory Study of Applying Ubiquitous Technology to Retail Banking*

Jongtae Yu, Mississippi State University

Chengqi Guo, Mississippi State University

*Factors Influencing the University Selection of International Students:*

*Do Students Understand and Consider AACSB Accreditation?*

Cynthia Daily, University of Arkansas at Little Rock

Stephanie Farewell, University of Arkansas at Little Rock

Gaurav Kumar, University of Arkansas at Little Rock

*Online Delivery of Accounting Courses: Student Perceptions*

Michael Watters, Henderson State University

Paul J. "Jep" Robertson, Henderson State University

*The Effective Use of Simulations in Business Courses*

L. Jeff Seaton, Murray State University

Michael W. Boyd, Western Carolina University

---

3:00 PM to 5:00 PM Thursday, April 3

Tupelo (D)

---

**Interdisciplinary Session**

**Session Chair:** Sharad Maheshwari, Hampton University

*A Cross-cultural Analysis of Unionization Trends and Variation in Collective Bargaining*  
Nini Yang, San Francisco State University

*Ethics Education in U. S. Accounting Practice – A Status Report*  
Homer Bates, University of North Florida  
Bobby Waldrup, University of North Florida  
Charles Calhoun, University of North Florida

*U.S. Mergers and Acquisitions: A Test of Market Efficiency*  
Nick Von Gersdorff, Longwood University  
Frank Bacon, Longwood University

*Quantitatively Considering State Defense Force Volunteers:  
Organizational Perceptions of Commissioned Officers Versus Non-Commissioned Personnel*  
Daniel Adrian Doss, Belhaven College  
Don W. Jones, Belhaven College  
William Sumrall, Belhaven College

*Residential Real Estate Rents and Values in Moscow vs. Philadelphia  
– An Historical Perspective*  
Paul Marshall, Widener University  
Hasan Valiullin, International University "Dubna"

*Development of a Practical Fleet Vehicle Replacement Policy  
for a Federal Government Contractor*  
Sharad Maheshwari, Hampton University  
Sid Credle, Hampton University

3:00 PM to 5:00 PM Thursday, April 3

Cypress (G)

**Interdisciplinary Session**

**Session Chair:** Steve Brown, Eastern Kentucky University

*Cash Flow from Accountants to End Users*  
Hassan Said, Austin Peay State University

*The Risks of Intangible Assets in Financial Statements*  
Mahmut Yardimcioglu, Karamanoglu Mehmetbey University

*Comparing Two Exchange Rate Regimes under Purchasing Power Parity and Disparity*  
Deergha Adhikari, University of Louisiana, Lafayette  
Kishor Guru-Gharana, McNeese State University

*Investigating the Effects of Standardization on Local IT Management:  
A Case Study of Global Corporation*  
Jongtae Yu, Mississippi State University  
Chengqi Guo, Mississippi State University

*Quality Levels of For-profit and Non-profit Competitors: A Review of Studies in Health Care*  
Randall Jarmon, West Texas A&M University

*Assessing Quality Management Strategy: Process and Methodology*  
Steve Brown, Eastern Kentucky University  
Chris Blades, Eastern Kentucky University  
Mark Casr, Eastern Kentucky University  
Norb Elbert, Eastern Kentucky University  
Maurice Reid, Eastern Kentucky University

---

3:00 PM to 5:00 PM Thursday, April 3

Executive Conference Room

---

**Interdisciplinary Session**

**Session Chair:** James Reagan McLaurin, American University of Sharjah

*Examining State Sponsored Lotteries and Their Effect on Bankruptcy Filing Rates:  
A Time Series Analysis*

Robert J. Landry, III, Jacksonville State University  
S. Keith Lowe, Jacksonville State University  
Benjamin B. Boozer, Jr., Jacksonville State University

*Economic Factors and Demand for Apartments*  
Michael Hanna, University of Houston - Clear Lake  
Stephen Caples, McNeese State University  
Charles Smith, University of Houston - Downtown

*Diversity and School District Funding*  
Peter Mitias, American University of Sharjah

*Applying the Law of Conservation of Volupower to Global Analysis of Nation-States*

Andrei Aleinikov, International Academy of Genius  
David Smarsh, International Academy of Genius

*Leadership in the City of Gold: An Arabian Adventure of Modern Management  
Capabilities in the 21st Century*

James Reagan McLaurin, American University of Sharjah

8:00 AM to 10:00 AM Friday, April 4

Magnolia (E)

**Interdisciplinary Session**

**Session Chair:** Denise Woodbury, Southern Utah University

*Academic Dishonesty and Intention to Cheat: A Model on 'Active' Versus  
'Passive' Academic Dishonesty as Perceived by Business Students*

Ismet Anitsal, Tennessee Tech University  
M. Meral Anitsal, Tennessee Tech University  
Robert Elmore, Tennessee Tech University

*The Effects of Distance and Proximity on Collaboration Software Evaluation*

Barbara Jo White, Western Carolina University  
Jo Ann E. Brown, Radford University

*A Curricular–Co-Curricular Approach to Student Leadership Development*

Neil Gilchrist, Truman State University  
Lou Ann Gilchrist, Truman State University

*A New Twist on E-Commerce: Educational Tutoring Originating in India*

Charlene Dykman, University of St. Thomas  
Beena George, University of St. Thomas

*The Career Portfolio – Teaching Students to Market Themselves*

Denise Woodbury, Southern Utah University  
William Neal, Brigham Young University - Hawaii  
Lon Addams, Weber State University

---

8:00 AM to 10:00 AM Friday, April 4

Cypress (G)

---

**Interdisciplinary Session**

**Session Chair:** Don Bradley, III, University of Central Arkansas

*Entrepreneurs with Disabilities:*

*The Role of Assistive Technology, Current Status and Future Outlook*

Rose Angelocci, The University of New Orleans

Kenneth J. Lacho, The University of New Orleans

Kenneth D. Lacho, The University of New Orleans

William Galle, The University of New Orleans

*A Sex-Based Analysis of Self-Employment Earnings*

Thomas Martin, Penn State University

*Health Insurance Coverage Among the Self-employed*

Sherry Robinson, Penn State University

*Response to Hurricane Katrina: A Small Business Approach*

John Cater, Nicholls State University

Ken Chadwick, Nicholls State University

*Studying Religious Entrepreneurs: Christian Entrepreneurs as Opportunity Exploiters,  
Social Entrepreneurs, and Proselytizers*

Don Bradley, III, University of Central Arkansas

Dawn Drinkwater, Dillard's Department Stores

Michael Rubach, University of Central Arkansas

8:00 AM to 10:00 AM Friday, April 4

Live Oak (B)

**Interdisciplinary Session**

**Session Chair:** Linda Bressler, University of Houston-Downtown

*Looking Before Leaping: The Effect of Owner Decisiveness on Small Business Performance*

John Leaptrott, Georgia Southern University

Michael McDonald, Georgia Southern University

*Are Entrepreneurs Optimistic, Realistic, Both or Fuzzy?*

*Relationship Between Entrepreneurial Traits and Entrepreneurial Learning*

Kathleen Liang, University of Vermont

Paul Dunn, University of Louisiana at Monroe

*Health Insurance Tax Incentives for Small Business Owners and Employees*

Calvin Bacon, University of South Alabama

*Unlocking Academic Entrepreneurship: The Role of Technology Maturation*

Russell Teasley, North Georgia College and State University

Frank Lockwood, Western Carolina University

*A Survey of Small Manufacturing Firms and Their Views on the Current State of the Economy*

Martin Bressler, Houston Baptist University

Linda Bressler, University of Houston-Downtown

---

8:00 AM to 10:00 AM Friday, April 4Tupelo (D)

---

**Interdisciplinary Session****Session Chair:** Thomas Box, Pittsburg State University*Optimizing the Advertising Budget for a Regional Business: The Case of Cycle World*

Lihui Bai, Valparaiso University

Paul Newsom, Valparaiso University

*Case Study: Zippo Manufacturing Company*

Kathleen Premo, St. Bonaventure University

Darwin King, St. Bonaventure University

*Long Term Survival and Quality Information Systems: A Longitudinal Case Study*

Judith Harris, Nova Southeastern University

Thomas Tworoger, Nova Southeastern University

Leslie Tworoger, Nova Southeastern University

*Case Study: Transforming from a Service-Based to a Products-Based Business*

John Kaliski, Minnesota State University, Mankato

Queen Booker, Minnesota State University, Mankato

*A Comparison of Liquidity and Cash Flow Ratios of Healthy and Unhealthy OTC Firms:**A Helpful Tool for the Instructors of Introductory Finance Courses*

Ravindra Kamath, Cleveland State University

Yihong He, Monmouth University

*Southwest Airlines 2007*

Thomas Box, Pittsburg State University

Kent Byus, Texas A&amp;M University-Corpus Christi

10:10 AM to 12:10 PM Friday, April 4

Magnolia (E)

**Interdisciplinary Session**

**Session Chair:** Larry Dale, Arkansas State University

*Government Affairs Activities of Chambers of Commerce*  
Kenneth Lacho, The University of New Orleans

*An Analysis of the Performance Impact of Information Systems Design and Business Strategy:  
The Case of Information Scope and Organizational Proactiveness*

Arthur Gilbert, University of West Florida  
Randall Reid, University of West Florida

*Donor's Remorse and Broken Promises: The Enforceability of Charitable Pledges*

Patricia Robertson, Arkansas State University  
Mark Lewis, Arkansas State University

*When Does Communication Become Miscommunication?*

Sam Faught, Lambuth University  
Mike McCullough, University of Tennessee at Martin  
Cooper Johnson, Delta State University

*Body Adornment:*

*A Comparison of the Attitudes of Business People and Students in Three States*

Larry Dale, Arkansas State University  
Sandra Bevill, Arkansas State University  
Terry Roach, Arkansas State University  
Susan Glasgow, Arkansas State University  
Courtney Bracy, Arkansas State University

---

10:10 AM to 12:10 PM Friday, April 4

Cypress (G)

---

**Interdisciplinary Session**

**Session Chair:** F. Dianne Lux Wigand, University of Arkansas at Little Rock

*Understanding the Uniformed Services Employment and Reemployment Rights Act:  
Several Demonstrative Cases*

Neal Thomson, Columbus State University

*The Performance and Determinants of Firms That Reprice Options  
During a Bear Market*

Paul Newsom, Valparaiso University

*International Stock Market Diversification*  
Ronald Kettering, Columbus State University

*The Wal-Mart Effect on the Securities Market*  
Ron Stunda, Birmingham-Southern College

*A Comparative Study of Tax Evasion in Six Countries*  
Robert McGee, Florida International University  
Inge Nickerson, Barry University  
Larry Pleshko, Kuwait University

*Newly Emerging Organizational and Coordination Forms*  
F. Dianne Lux Wigand, University of Arkansas at Little Rock

10:10 AM to 12:10 PM Friday, April 4

Live Oak (B)

**Interdisciplinary Session**

**Session Chair:** Stephen Betts, William Paterson University

*Management and Organizational Learning: An Unintended Benefit from a Recruiting Strategy*

Regina Greenwood, Nova Southeastern University

Leslie Tworoger, Nova Southeastern University

*A Profile of Finance Educators in the U.S.*

Ravindra Kamath, Cleveland State University

Yi Wang, Cleveland State University

*Student Evaluations of Course Attributes of Online Courses Versus On-ground Courses:*

*Impact of Student Personality Traits*

M. Meral Anitsal, Tennessee Tech University

Ismet Anitsal, Tennessee Tech University

Bonita Barger, Tennessee Tech University

Ismail Fidan, Tennessee Tech University

Michael R. Allen, Tennessee Tech University

*District Level Mandates and High School Students' Understanding of Economics*

Paul W. Grimes, Mississippi State University

Meghan J. Millea, Mississippi State University

M. Kathleen Thomas, Mississippi State University

*Teaching and Assessing Basic Concepts to Advanced Applications:*

*Using Bloom's Taxonomy to Inform Graduate Course Design*

Stephen Betts, William Paterson University

---

10:10 AM to 12:10 PM Friday, April 4Tupelo (D)

---

**Interdisciplinary Session****Session Chair:** Gerald Calvasina, Southern Utah University*Insurance Coverage Transitions and the Use of Preventive Services*

Stephan Gohmann, The University of Louisville

Mrya McCrickard, Bellarmine University

Alan Deck, Bellarmine University

*Comparison of the Back Propagation Neural Network Model,  
Bayesian Chiao's Model and Sarima Model in Forecasting Korean Stock Price Index*

Kyung Joo Lee, University of Maryland Eastern Shore

Albert Chi, University of Maryland Eastern Shore

Sehwan Yoo, University of Maryland Eastern Shore

John Jin, University of Maryland Eastern Shore

*The Use of Standardized Accounting Packages to Assess Credit Risk: The Case of Cash*

Kurt Jesswein, Sam Houston State University

*Exempt Income and Marginal Tax Rates*

Peter Westort, University of Wisconsin Oshkosh

*Exempt Entities and Tax Simulations on the Uniform CPA Examination*

Thomas Moncada, Eastern Illinois University

Susan Moncada, Indiana State University

*Beware the Full Cost Allocation Mistake in Management Decision Making*

Richard Calvasina, University of West Florida

Gerald Calvasina, Southern Utah University

Eugene Calvasina, Southern University

---

12:50 PM to 2:50 PM Friday, April 4

Magnolia (E)

---

**Interdisciplinary Session**

**Session Chair:** Sandra Bevill, Arkansas State University

*Cultural Moderators in the International Diffusion of Manufacturing Practices*

Sam Kelley, Bloomington Health

David McCalman, University of Central Arkansas

Jonathan Lee, University of Windsor

*An International Study of the Relation Between Book-Tax Conformity  
and the Value Relevance of Earnings Components*

Sung Wook Yoon, California State University, Northridge

*Goldratt's Thinking Process Applied to the Problems Associated with the Glass Ceiling Effect*

Lloyd J. Taylor, III, University of Texas of the Permian Basin

Jenny Waggoner, University of South Florida St. Petersburg

*Macromarketing and Market Orientation Effects on Economic Growth:  
A Conceptualization Model*

Rodney Oudan, Worcester State College

*Web 2.0: New Web-Based Communication Tools Defined and Explained*

Sandra Bevill, Arkansas State University

Courtney Bracy, Arkansas State University

Georgia Hale, University of Arkansas Fort Smith

---

12:50 PM to 2:50 PM Friday, April 4Cypress (G)

---

**Interdisciplinary Session****Session Chair:** Susan Moncada, Indiana State University*Who's a Leader?: Students' Implicit Theories of Leadership*

Stephen Betts, William Paterson University

William Morgan, Felician College

Beth Castiglia, Felician College

*Differential Effects of Student Characteristics on Performance:**Online Vis-à-Vis Offline Accounting Courses*

Sungkyoo Huh, California State University-San Bernardino

Jongdae Jin, University of Maryland Eastern Shore

Kyung Joo Lee, University of Maryland Eastern Shore

Sehwan Yoo, University of Maryland Eastern Shore

*More "Private" than Private Institutions:**Public Institutions of Higher Education and Financial Management*

Olin Adams, Auburn University

Rebecca Robichaux, Mississippi State University

A.J. Guarino, Auburn University

*Philosophical Foundations in Business Education*

Barry Padgett, Bellarmine University

*An Examination of Ethical Values among Black and White Subjects  
and among Males and Females*

Sandra Hartman, University of New Orleans

Lillian Fok, University of New Orleans

Susan Zee, Southeastern Louisiana University

*Merlot: Benefits for Accounting and Finance Educators*

Susan Moncada, Indiana State University

Thomas Moncada, Eastern Illinois University

12:50 PM to 2:50 PM Friday, April 4

Live Oak (B)

**Interdisciplinary Session**

**Session Chair:** Sarah Colby, East Carolina University

*Examining Shifts in Online Purchasing Behavior: Decoding the 'Net Generation'*

Donghyun Kim, University of Mississippi  
Anthony P. Ammeter, University of Mississippi

*The Changing of Heritage Pride and Advertising Effectiveness: A Mexican Comparison*

Cecilia Maldonado, Georgia Southwestern State University  
Susana Lazo, ITESM, Campus Monterrey  
Adriana Carranza, ITESM, Campus Monterrey

*E-Commerce in Non-Metro Regions: On-line Purchases and Implications for Businesses*

Adee Athiyaman, Western Illinois University

*Multichannel Shopping and Satisfaction:*

*The Role of Shopping Experience and Customer-Firm Relationship Characteristics*

Young-Hyuck Joo, Hansung University, Korea

*Nutrition Marketing on Food Labels*

Sarah Colby, East Carolina University

---

12:50 PM to 2:50 PM Friday, April 4

Tupelo (D)

---

**Interdisciplinary Session**

**Session Chair:** Inge Nickerson, Barry University

*Methodological Issues in Analyzing Financial Statements in the Presence of Operating Leases*

Kurt Jesswein, Sam Houston State University

*A Model for Self-Employment Training for People with Disabilities*

William Galle, The University of New Orleans

Kenneth Lacho, The University of New Orleans

*The Wealth Transfer Taxes: Selected Impedimenta to Their Abrogation.*

Jean Marie Banatte, Norfolk State University

Jim Chen, Norfolk State University

*To Tax or Not to Tax? Foreign and Domestic Taxation of the Internet*

Ken Griffin, University of Central Arkansas

Mark McMurtrey, University of Central Arkansas

LeaAnn Smith, University of Central Arkansas

*Presenting the Dimensionality of an Ethics Scale Pertaining to Tax Evasion*

Inge Nickerson, Barry University

Larry Pleshko, Kuwait University

Robert McGee, Florida International University

3:00 PM to 5:00 PM Friday, April 4

Magnolia (E)

**Interdisciplinary Session**

**Session Chair:** Stephen Betts, William Paterson University

*Short Term Market Reaction to Earnings Restatements:*

*Value Stocks Vis-à-vis Glamour Stocks*

Tan Xu, Old Dominion University

Diane Li, University of Maryland-Eastern Shore

John Jin, University of Maryland-Eastern Shore

*Expanding Managerial Consciousness: Leadership Advice From the Bhagavad Gita*

Charles Rarick, Barry University

Inge Nickerson, Barry University

*Conceptualizing Retail Atmospherics in the Online Shopping Context*

Stuart Heyworth, University of Canterbury

Jai Lyons, University of Canterbury

Jamye Foster, University of Canterbury

*Economics of Resource Based and Dynamic Capabilities View: A Contemporary Framework*

Satyanarayana Parayitam, McNeese State University

Kishor Guru-Gharana, McNeese State University

*Guerrillas in Our Midst:*

*When Entrepreneurs Should and Should Not Use Unconventional Marketing*

Stephen Betts, William Paterson University

Dennis Huzey, Felician College

---

3:00 PM to 5:00 PM Friday, April 4

Cypress (G)

---

### **Interdisciplinary Session**

**Session Chair:** Leslie Toombs, University of Texas of the Permian Basin

*An Exploration into Modeling Sustainable Consumption:*

*The Case of Animal-Based Traditional Medicines*

Adee Athiyaman, Western Illinois University

*Generational Differences in the Workplace: The Future?*

Linda Shonesy, Athens State University

Robert Gulbro, Athens State University

*A Model Self-Employment Policy Program for People with Disabilities*

William Galle, The University of New Orleans

Kenneth Lacho, The University of New Orleans

*Raising Cane's Response to Hurricane Katrina*

John Cater, Nicholls State University

Ken Chadwick, Nicholls State University

*The Creole Skillet Restaurant: A Post Katrina Start up*

Kenneth Lacho, The University of New Orleans

Anne Kiefer, The Creole Skillet

*Renovar Energy Corporation*

Leslie Toombs, University of Texas of the Permian Basin

Jack Ladd, University of Texas of the Permian Basin

---

3:00 PM to 5:00 PM Friday, April 4

Tupelo (D)

---

**Interdisciplinary Session**

**Session Chair:** Hadley Leavell, Sam Houston State University

*Why So Much Fuss about Globalization?*

Tanya Gray, Sam Houston State University

Balasundram Maniam, Sam Houston State University

*Earnings Management, Ethics, and the Capital Markets*

Robert L. Putman, University of Tennessee at Martin

Richard B. Griffin, University of Tennessee at Martin

Ronald W. Kilgore, University of Tennessee at Martin

*The Evolution of a Key Provision of the Internal Revenue Code: The Home Office Deduction*

Jean Marie Banatte, Norfolk State University

Desta Damtew, Norfolk State University

*Globalization of Financial Markets and Reflection to Turkish Small  
and Medium Scale Enterprises: Basel II*

Mahmut Yardimcioglu, Karamanoglu Mehmetbey University

Selcuk Kendirli, Hitit University

*Working Capital Management in a Global Environment*

Hadley Leavell, Sam Houston State University

---

6:00 PM to 8:30 PM Friday, April 4

Live Oak (C)

---

Dinner Buffet, Awards Reception and Cash Bar

6:00 Bar Opens

6:30 Dinner is served!

**Interdisciplinary Internet Session**  
**Session Chair: Jim Carland, Allied Academies**

*A Comparative Analysis of Grading Practices by Discipline Within a College of Business*

Michael Barth, The Citadel  
 Jun Liu, Georgia Southern University  
 William Wells, Georgia Southern University

*Quantitatively Examining the Community Service, Burnout, and Duty Perceptions of Commissioned Officers Versus Non-Commissioned Personnel of a Southern State Defense Force*

Don W. Jones, Belhaven College  
 D. Adrian Doss, Belhaven College  
 William H. Sumrall, Belhaven College

*Examining the Perceptions of Commissioned Officers Versus Non-Commissioned Personnel of a State Defense Force: Medical Conditions, Family Supportiveness, and Job Satisfaction*

Don W. Jones, Belhaven College  
 William H. Sumrall, Belhaven College  
 D. Adrian Doss, Belhaven College

*A Proposed Variation of the Capability Maturity Model Framework among Financial Management Settings*

Daniel Adrian Doss, Belhaven College  
 I Chun Lisa Chen, Yuanpei University  
 Lacey D. Holland, Mississippi University for Women

*Volunteer Service: Quantitatively Examining the Organizational Perceptions of Commissioned Officers Versus Non-Commissioned Personnel of a State Defense Force*

Daniel Adrian Doss, Belhaven College  
 William Sumrall, Belhaven College  
 Don W. Jones, Belhaven College

*Service Perceptions of Commissioned Officers Versus Non-Commissioned Personnel of a State Defense Force Concerning Achievements, Promotions, and Duty Time*

William H. Sumrall, Belhaven College  
 Daniel Adrian Doss, Belhaven College  
 Don W. Jones, Belhaven College

*Human Resource Information Systems in Crises*

Amy Hurley-Hanson, Chapman University  
 Cristina Giannantonio, Chapman University

**Interdisciplinary Internet Session**  
**Session Chair: JoAnn Carland, Allied Academies**

*Are Students Really Learning Anything?*  
Barbara Dalby, University of Mary Hardin Baylor  
Chrisann Merriman, University of Mary Hardin Baylor

*Hedonic Motivations for and Dependency on Online Shopping*  
Chih-Chien Wang, National Taipei University  
Yu-Tzu Chen, National Taipei University

*Internet Marketing, E-bay, and Entrepreneurship in China, Lithuania, the Netherlands, Thailand, & the USA:  
Ethical and Legal Issues*  
Burt Nomiya, Cameron University  
Shawn Carraher, Cameron University  
John Courington, Cameron University  
Cynthia Johnson, Cameron University

*Business Plan Development for Service Ventures:  
Integrating Customer Experience Management*  
Eileen Wall, St. Mary's University  
Brooke R. Envick, St. Mary's University

*The Nairobi Stock Exchange and New Equity Capital: 1998 to 2004*  
John Parkinson, York University, Canada  
Nelson Waweru, York University, Canada

*Assessing Globally Themed Learning Objectives Using Objective Examination Results*  
Laura Fitzpatrick, Rockhurst University

*When the Goal Is Creating a Brand Personality, Focus on User Imagery*  
Bryan Hayes, Mississippi College  
Bruce Alford, Louisiana Tech University  
Louis Capella, Mississippi State University

*The Unthinkable Occurs in Pleasantville: Workplace Violence Hits Home*  
Carrol Haggard, Fort Hays State University  
Patricia LaPoint, McMurry University

---

**DISTINGUISHED RESEARCH AWARD WINNERS**

We would like to congratulate the Distinguished Research Award Winners. The competition was extremely rigorous and intense. After extensive review, the panel of judges awarded distinguished research status to 25% of the manuscripts. The authors of the following works will receive engraved plaques, and the manuscripts will be published in the next regularly scheduled issue of the appropriate *journal*.

---

**Academy of Accounting and Financial Studies**

*The Negative Effect of the Marriage Penalty Tax on American Society*

Frederick J. Feucht, Prairie View A&M University

L. Murphy Smith, Texas A&M University

Robert H. Strawser, Texas A&M University

*Short Term Market Reaction to Earnings Restatements:*

*Value Stocks Vis-à-Vis Glamour Stocks*

Tan Xu, Old Dominion University

Diane Li, University of Maryland-Eastern Shore

John Jongdae Jin, University of Maryland-Eastern Shore

*The Performance and Determinants of Firms That Reprice Options During a Bear Market*

Paul Newsom, Valparaiso University

*Methodological Issues in Analyzing Financial Statements in the Presence of Operating Leases*

Kurt R. Jesswein, Sam Houston State University

*The Wal-Mart Effect on the Securities Market*

Ronald A. Stunda, Birmingham-Southern College

*An Analysis of the Relationships Among Information Scope, Organizational Proactiveness,  
and Firm Performance*

Arthur H. Gilbert, Jr., University of West Florida

Randall C. Reid, University of West Florida

## **Academy of Economics and Economic Education**

### *District Level Mandates and High School Students' Understanding of Economics*

Paul W. Grimes, Mississippi State University  
Meghan J. Millea, Mississippi State University  
M. Kathleen Thomas, Mississippi State University

### *Financial Literacy and "I Don't Know"*

Robert Hill, University of Houston-Clear Lake  
Grady Perdue, University of Houston-Clear Lake

### *Assessing Globally Themed Learning Objectives Using Objective Examination Results*

Laura E. Fitzpatrick, Rockhurst University

## **Academy of Educational Leadership**

### *Body Adornment:*

#### *A Comparison of the Attitudes of Business People and Students in Three States*

Larry R. Dale, Arkansas State University  
Sandra Bevill, Arkansas State University  
Terry Roach, Arkansas State University  
Susan Glasgow, Arkansas State University  
Courtney Bracy, Arkansas State University

### *Academic Dishonesty and Intention to Cheat:*

#### *A Model of 'Active' Versus 'Passive' Academic Dishonesty as Perceived by Business Students*

Ismet Anitsal, Tennessee Tech University  
M. Meral Anitsal, Tennessee Tech University  
Robert Elmore, Tennessee Tech University

### *Differential Effects of Student Characteristics on Performance:*

#### *Online vis-à-vis Offline Accounting Courses*

Sungkyoo Huh, California State University-San Bernardino  
Jongdae Jin, University of Maryland-Eastern Shore  
Kyung Joo Lee, University of Maryland-Eastern Shore  
Sehwan Yoo, University of Maryland-Eastern Shore

*A New Twist on E-Commerce:  
Educational Tutoring Originating in India*  
Charlene Dykman, University of St. Thomas  
Beena George, University of St. Thomas

*Academic Publishing and Teaching Effectiveness:  
An Attitudinal Study of AACSB Accredited Business School Faculty*  
Robert L. Taylor, Radford University  
Angela D'Auria Stanton, Radford University

## **Academy of Entrepreneurship**

### **Academy of Entrepreneurship Journal**

*Looking Before Leaping: The Effect of Owner Decisiveness on Small Business Performance*  
John Leaptrott, Georgia Southern University  
J. Michael McDonald, Georgia Southern University

*Are Entrepreneurs Optimistic, Realistic, Both or Fuzzy?  
The Relationship Between Entrepreneurial Traits and Entrepreneurial Learning*  
Chyi-lyi (Kathleen) Liang, The University of Vermont  
Paul Dunn, The University of Louisiana at Monroe

### **Entrepreneurial Executive**

*The Evolution of a Key Internal Revenue Code Section: The Home Office Deduction*  
Jean-Marie Banatte, Norfolk State University  
Desta Damtew, Norfolk State University

*Health Insurance Coverage Among the Self-Employed*  
Sherry Robinson, Penn Sate University

*Business Plan Development for Service Ventures:  
Integrating Customer Experience Management*  
Eileen Wall, St. Mary's University  
Brooke R. Envick, St. Mary's University

---

## **International Journal of Entrepreneurship**

*Recent Evidence of Small Business Development in Transition Economies*

Jung-Wan Lee, Kazakh-British Technical University  
Tantatape Brahmasrene, Purdue University North Central  
Simon W. Tai, Kazakhstan Institute of Management

*Globalization of Financial Markets and Reflection to Turkish  
Small and Medium Scale Enterprises: Basel II*

Mahmut Yardimcioglu, Karamanoglu Mehmetbey University  
Selcuk Kendirli, Hitit University

## **Academy of Entrepreneurship Education**

### **Journal of Entrepreneurship Education**

*A Model for Self-Employment Training for People with Disabilities*

William P. Galle, Jr., The University of New Orleans  
Kenneth J. Lacho, The University of New Orleans

## **Academy of Health Care Management**

*Process Performance Measurement with Automatically Collected Data  
A Case Study in an Outpatient Clinic*

Markus Kohlbacher, Graz University of Technology  
Andreas Gautsch, KNAPP Systems Integration  
Hartwig Zenz, Steiermaerkische Krankenanstaltenges  
Werner Leodolter, Steiermaerkische Krankenanstaltenges

## **Academy of Legal, Ethical and Regulatory Issues**

*Examining State Sponsored Lotteries and Their Effect on Bankruptcy Filing Rates:*

*A Time Series Analysis*

Robert J. Landry, III, Jacksonville State University  
S. Keith Lowe, Jacksonville State University  
Benjamin B. Boozer, Jr., Jacksonville State University

*Donor's Remorse and Broken Promises: The Enforceability of Charitable Pledges*

Patricia Quinn Robertson, Arkansas State University

James Mark Lewis, Arkansas State University

*Presenting the Dimensionality of an Ethics Scale Pertaining to Tax Evasion*

Inge Nickerson, Barry University

Larry P. Pleshko, Kuwait University

Robert W. McGee, Florida International University

*An Examination of Ethical Values among Black and White Subjects and among Males and Females*

Sandra J. Hartman, University of New Orleans

Lillian Y. Fok, University of New Orleans

Susan M. L. Zee, Southeastern Louisiana University

*Ethics Education in U.S. Accounting Practice: A Status Report*

Homer L. Bates, University of North Florida

Bobby E. Waldrup, University of North Florida

Charles H. Calhoun, III, University of North Florida

*The Impact of Earnings Management on Capital Markets: Ethical Consideration of the Players*

Robert L. Putman, University of Tennessee at Martin

Richard B. Griffin, University of Tennessee at Martin

Ronald W. Kilgore, University of Tennessee at Martin

## **Academy of Marketing Studies**

*When the Goal is Creating a Brand Personality, Focus on User Imagery*

J. Bryan Hayes, Mississippi College

Bruce L. Alford, Louisiana Tech University

Louis M. Capella, Mississippi State University

*Hedonic Motivations for and Dependency on Online Shopping*

Chih-Chien Wang, National Taipei University

Y-Tzu Chen, National Taipei University

*E-Commerce in Non-Metro Regions: On-Line Purchases and Implications for Businesses*

Adee Athiyaman, Western Illinois University

## **Academy of Organizational Culture, Communications and Conflict**

*From Work-Family Conflicts to Psychological Stress, Job Satisfaction  
and to Life Satisfaction: A Proposed Integrative Model*

Satyanarayana Parayitam, McNeese State University  
Narender Kumar Kalra, University of Delhi

*The Effect of Global Strategy of Firms on Local IT Managers and IT Management:*

*Focus on Factors Affecting Conflicts*

Jongtae Yu, Mississippi State University  
Chengqi Guo, Mississippi State University

*Who's a Leader? Students' Implicit Theories of Leadership*

Stephen C. Betts, William Paterson University  
William Morgan, Felician College  
Beth Castiglia, Felician College

*Understanding the New Generation:*

*What the Millennial Cohort Absolutely, Positively Must Have at Work*

Claudia Rawlins, California State University  
Julie Indvik, California State University  
Pamela R. Johnson, California State University

## **Academy of Strategic Management**

*Economics of Resource Based and Dynamic Capabilities View:*

*A Contemporary Framework*

Satyanarayana Parayitam, McNeese State University  
Kishor Guru-Gharana, McNeese State University

## **Academy of Studies in International Business**

*Why So Much Fuss About Globalization?*

Tanya Gray, Sam Houston State University  
Balasundram Maniam, Sam Houston State University

*An International Study of the Relation Between Book-Tax Conformity  
and the Value of Relevance of Earnings Components*

Sung Wook Yoon, California State University, Northridge

*The Nairobi Stock Exchange and New Equity Capital: 1998 to 2004*

John M. Parkinson, York University

Nelson M. Waweru, York University

*A Cross-Cultural Analysis of Unionization Trends and Variation in Collective Bargaining*

Nini Yang, San Francisco State University

*Leadership in the City of Gold:*

*An Arabian Adventure of Modern Management Capabilities in the 21<sup>st</sup> Century*

James Reagan McLaurin, American University of Sharjah

### **International Academy for Case Studies**

*The Development of a Fleet Vehicle Replacement Policy for a Federal Government Contractor*

Sharad Maheshwari, Hampton University

Sid Howard Credle, Hampton University

*Workplace Violence Hits Home: Are You Ready?*

Carrol Haggard, Fort Hays State University

Patricia LaPoint, McMurry University

*Southwest Airlines 2007*

Thomas M. Box, Pittsburg State University

Kent Byus, Texas A&M University-Corpus Christi

---

**ACADEMY OF EDUCATIONAL LEADERSHIP  
CREATIVE AND INNOVATIVE TEACHING AWARDS**

---

The Academy of Educational Leadership sponsors special awards to recognize innovative and creative teachers and educational programs. To be eligible for consideration, an individual must be nominated by a member of the Allied Academies and undergo evaluation by the Teaching Awards Committee. The following individuals have met the criteria and have been judged by the Committee to be worthy of the designation, Distinguished Teachers. We extend to them our sincere congratulations.

---

Lawrence Raymond Dale, Arkansas State University

Darwin L. King, St. Bonaventure University

Martin Meyers, University of Wisconsin at Stevens Point

Barry L. Padgett, Bellarmine University

---

**ACADEMY OF EDUCATIONAL LEADERSHIP  
CREATIVE AND INNOVATIVE EDUCATION AWARD**

---

The criteria for recognition include the on going delivery of outstanding instruction and education, and, the practice of innovative and creative education. Any academic unit of a college or university is eligible for consideration, but a unit may not win the award more than once. The following unit has met the criteria and has been judged by the Committee to be worthy of the Distinguished Education Award.

---

Carland College

---

**THE ALLIED ACADEMIES FELLOW AWARD**

---

These individuals have been supporters of the Allied Academies for many years. They have encouraged attendance at the conferences, worked as Referees and Ambassadors-at-Large, and have taken on extra duties on our behalf. They have been good friends and colleagues, and are clearly worthy of Fellow status.

---

Don B. Bradley, III, Central Arkansas University

Denise Woodbury, Southern Utah University

---

**THE LARRY R. WATTS DISTINGUISHED SERVICE AWARD**

---

Dr. Larry R. Watts extended extraordinary service to the Allied Academies throughout the establishment and growth of the organization and the development of its various Academies and *Journals*. This award, named in his honor, is bestowed only upon Academy Fellows who make outstanding contributions to the organization above and beyond the normal call of duty. For his unwavering support and constant enthusiasm, we thank...

---

D. K. "Skip" Smith, Southeast Missouri State University

---

## INDEX OF PARTICIPANTS

Adams, O. ....	26	Capella, L. ....	33, 38
Addams, L. ....	17	Caples, S. ....	16
Adhikari, D. ....	15	Carr, R. ....	7
Aleinikov, A. ....	11, 16	Carraher, S. ....	3, 33
Alford, B. ....	38	Carranza, A. ....	27
Allen, M. ....	23	Case, C. ....	10
Ammeter, A. ....	27	Casr, M. ....	15
Angelocci, R. ....	18	Castiglia, B. ....	26, 39
Anitsal, I. ....	17, 23, 35	Cater, J. ....	18, 30
Anitsal, M. ....	17, 23, 35	Chadwick, K. ....	18, 30
Athiyaman, A. ....	27, 30, 38	Chen, I. ....	4, 5, 32
Bacon, C. ....	19	Chen, J. ....	28
Bacon, F. ....	11, 14	Chen, Y. ....	33, 38
Bai, L. ....	20	Chi, A. ....	24
Banatte, J. ....	28, 31, 36	Choi, S. ....	5
Baqer, S. ....	9	Clark, S. ....	3
Barbour, K. ....	7, 12	Colby, S. ....	27
Barger, B. ....	23	Courington, J. ....	3, 33
Barth, M. ....	32	Credle, S. ....	14, 40
Bates, H. ....	14, 38	Daily, C. ....	13
Beale, R. ....	4	Dalby, B. ....	33
Bell, C. ....	8	Dale, L. ....	21, 35, 41
Bell, J. ....	12	Damtew, D. ....	31, 36
Betts, S. ....	23, 26, 29, 39	Deck, A. ....	24
Bevill, S. ....	21, 25, 35	Donald, M. ....	3
Blades, C. ....	15	Doss, D. ....	3-5, 14, 32
Blaylock, B. ....	12	Dow, B. ....	8
Booker, Q. ....	20	Drinkwater, D. ....	18
Bookout, S. ....	3	Dunn, P. ....	19, 36
Boozer, B. ....	16, 37	Dykman, C. ....	17, 36
Box, T. ....	20, 40	Edwards, D. ....	6
Boyd, M. ....	13	Elbert, N. ....	15
Bracy, C. ....	21, 25, 35	Eldredge, B. ....	10
Bradley, D. ....	18, 42	Elmore, R. ....	17, 35
Brahmasrene, T. ....	6, 8, 37	Ennis, K. ....	9
Breazeale, J. ....	8	Envick, B. ....	33, 36
Bressler, L. ....	19	Farewell, S. ....	13
Bressler, M. ....	19	Faught, S. ....	21
Brewer, P. ....	13	Feucht, F. ....	7, 34
Brown, J. ....	17	Fidan, I. ....	23
Brown, S. ....	13, 15	Fitzpatrick, L. ....	4, 33, 35
Burgess, S. ....	3	Fok, L. ....	26, 38
Burke, D. ....	3	Foster, C. ....	11
Byus, K. ....	20, 40	Foster, J. ....	29
Calhoun, C. ....	14, 38	Fowler, A. ....	4
Calvasina, E. ....	24	Galle, W. ....	18, 28, 30, 37
Calvasina, G. ....	24	Gaskins, J. ....	11
Calvasina, R. ....	24	Gautsch, A. ....	6, 37

George, B. ....	17, 36	Kiefer, A. ....	30
Giannantonio, c. ....	4, 32	Kile, J. ....	6
Gilbert, A. ....	21, 34	Kilgore, R. ....	31, 38
Gilchrist, L. ....	17	Kim, D. ....	27
Glasgow, S. ....	21, 35	King, D. ....	10, 20, 41
Gohmann, S. ....	24	Kohlbacher, M. ....	6, 37
Gray, T. ....	31, 39	Kumar, G. ....	13
Green, K. ....	10	Kunz, D. ....	6, 8
Greenwood, R. ....	23	Kyj, M. ....	9
Griffin, K. ....	28	Lacho, K. ....	18, 21, 28, 30, 37
Griffin, M. ....	6	Lacho, K. D. ....	18
Griffin, R. ....	31, 38	Ladd, J. ....	30
Grimes, P. ....	23, 35	Lambert, J. ....	11
Guarino, A. ....	26	Landry, R. ....	16, 37
Gulbro, R. ....	30	LaPoint, P. ....	33, 40
Guo, C. ....	13, 15, 39	Lazo, S. ....	27
Guru-Gharana, K. ....	15, 29, 39	Leaptrott, J. ....	19, 36
Ha, J. ....	5	Leavell, H. ....	31
Haggard, C. ....	33, 40	Lee, J. ....	8, 25, 37
Hale, G. ....	25	Lee, K. ....	24, 26, 35
Hammond, C. ....	5	Leodolter, W. ....	6, 37
Hanna, M. ....	16	Lewis, M. ....	4, 21, 38
Harrell, A. ....	11	Li, D. ....	29, 34
Harris, J. ....	20	Liang, K. ....	19, 36
Hartman, S. ....	26, 38	Linville, M. ....	5, 9
Hayes, B. ....	33, 38	Liu, J. ....	32
He, Y. ....	20	Lockwood, F. ....	19
Healey, B. ....	6, 8, 11	Lowe, K. ....	16, 37
Henard, K. ....	6	Lyons, J. ....	29
Heyworth, S. ....	29	Maheshwari, S. ....	14, 40
Hill, R. ....	10, 35	Maldonado, C. ....	27
Holland, L. ....	4, 5, 32	Maniam, B. ....	4, 31, 39
Huh, S. ....	26, 35	Marshall, P. ....	9, 14
Hurley-Hanson, A. ....	4, 32	Martin, T. ....	18
Huzey, D. ....	29	McCalman, D. ....	25
Indvik, J. ....	7, 39	McConnell, C. ....	4
Jarmon, R. ....	15	McCrickard, M. ....	24
Jesswein, K. ....	24, 28, 34	McCullough, M. ....	21
Jin, J. ....	24, 26, 29, 34, 35	McDonald, M. ....	19, 36
Johnson, C. ....	3, 21, 33	McFarland, M. ....	11
Johnson, P. ....	7, 10, 39	McGee, R. ....	22, 28, 38
Jones, D. ....	3, 14, 32	McGowan, M. ....	6
Joo, Y. ....	27	McLaurin, J. ....	11, 16, 40
Jordan, C. ....	3	McMurtrey, M. ....	28
Jung, S. ....	5	Medlin, B. ....	10
Kaliski, J. ....	20	Merriman, C. ....	33
Kalra, N. ....	9, 39	Meyers, M. ....	12, 41
Kamath, R. ....	20, 23	Millea, M. ....	23, 35
Kelley, S. ....	25	Miller, R. ....	3
Kendirli, S. ....	31, 37	Mitias, P. ....	16
Kettering, R. ....	22	Moncada, S. ....	24, 26

Moncada, T. ....	24, 26	Taylor, L. ....	25
Morgan, A. ....	7	Taylor, R. ....	7, 36
Morgan, W. ....	26, 39	Teasley, R. ....	19
Neal, W. ....	17	Thomas, K. ....	23, 35
Negrón, L. ....	3	Thomson, N. ....	22
Newsom, P. ....	20, 22, 34	Toombs, L. ....	30
Nicholas, N. ....	4	Totten, J. ....	3
Nickerson, I. ....	22, 28, 29, 38	Tucci, J. ....	9
Nixon, M. ....	3	Turner, J. ....	4
Nomiyama, B. ....	33	Tworoger, L. ....	20, 23
Oh, D. ....	5	Tworoger, T. ....	20
Oudan, R. ....	25	Valiullin, H. ....	14
Padgett, B. ....	26, 41	Von Gersdorff, N. ....	14
Parayitam, S. ....	9, 29, 39	Waggoner, J. ....	25
Parkinson, J. ....	33, 40	Waldrup, B. ....	14, 38
Perdue, G. ....	10, 35	Walker, K. ....	8
Pettypool, D. ....	12	Wall, E. ....	33, 36
Pittman, J. ....	4	Wang, C. ....	33, 38
Pleshko, L. ....	9, 22, 28, 38	Wang, Y. ....	23
Premo, K. ....	10, 20	Watters, M. ....	13
Putman, R. ....	31, 38	Waweru, N. ....	33, 40
Rarick, C. ....	29	Weiderman, I. ....	11
Rawlins, C. ....	7, 39	Wells, W. ....	32
Reid, M. ....	15	Westort, P. ....	24
Reid, R. ....	21, 34	White, B. ....	17
Ricks, J. ....	12	Wigand, D. ....	22
Roach, T. ....	21, 35	Wilson, A. ....	4
Roberts, W. ....	12	Wilson, L. ....	3
Robertson, J. ....	13	Woodbury, D. ....	17, 42
Robertson, P. ....	21, 38	Xu, T. ....	29, 34
Robichaux, R. ....	26	Yang, N. ....	14, 40
Robinson, S. ....	18, 36	Yardimcioglu, M. ....	15, 31, 37
Rubach, M. ....	18	Yoo, S. ....	24, 26, 35
Rutihinda, C. ....	4	Yoon, S. ....	25, 40
Ryan, D. ....	3	Yu, J. ....	5, 13, 15, 39
Said, H. ....	15	Zee, S. ....	26, 38
Schuldt, B. ....	3	Zenz, H. ....	6, 37
Seaton, J. ....	13		
Shonesy, L. ....	30		
Smarsh, D. ....	16		
Smith, C. ....	16		
Smith, D. ....	42		
Smith, L. ....	28		
Smith, M. ....	7, 34		
Smith, S. ....	6		
Stanton, A. ....	7, 36		
Strawser, R. ....	7, 34		
Stunda, R. ....	22, 34		
Summary, R. ....	6		
Sumrall, W. ....	3, 14, 32		
Tai, S. ....	8, 37		

- FIRST FLOOR**
1. Food Court
  2. Burger City
  3. Pizzeria Fresh
  4. Gold's Deli
  5. Gift Shop
  6. Change Booth
  7. L.A. Bar
  8. VIP Lounge
  9. Executive Casino Host
  10. Main Cashier's Cage
  11. ATM Location
  12. Atrium Cafe
  13. Chicago Steakhouse
  14. Restrooms
  15. Cashier's Cage
  16. Courtyard Buffet
  17. Restrooms
  18. Players Club
  19. ATM Location
  20. Bullion Bar
  21. Escalator to Theatre & Meeting Rooms
  22. ATM Location
  23. Ticket Redemption
  24. Elevators
  25. Restrooms
  26. Ticket Redemption
  27. Casino Entrance
  28. ATM Location
  29. Hotel Lobby
  30. Main Entrance
  31. Hotel Elevators
  32. Hotel
  33. Golden Reflections Spa
  34. Hotel Front Desk/Check-in
  35. Parking Garage Elevators
  36. Parking Garage

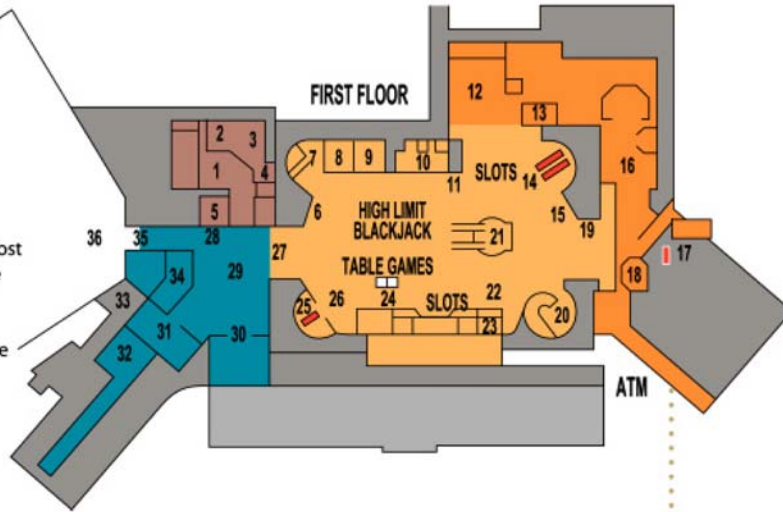

**SECOND FLOOR**

1. Poker Room
2. Slots & Video Poker
3. Live Oak Ballroom
- 3A. Live Oak A
- 3B. Live Oak B
- 3C. Live Oak C
4. Tupelo
5. Magnolia
6. Dogwood
7. Cypress
8. Restrooms
9. ATM Location
10. Men's Restroom
11. Women's Restroom
12. Box Office
13. Showroom Bar
14. Millennium Theatre

